

Shoalhaven District Memorial Hospital Redevelopment

EXPRESSION OF INTEREST 2025

acknowledgement of country

Cultural Capital acknowledges the Aboriginal and Torres Strait Islander peoples as Traditional Custodians of the lands and waters we now share. We pay our respects to the Jerrinja People and all Aboriginal and Torres Strait Islander People who live on the country where this project resides.

We pay tribute to their enduring culture, seeking to engage with and learn from them for the cultural enrichment of our community and our work.



summary of EOI

Cultural Capital has been appointed by Health Infrastructure NSW (HI) to curate the art program for the new Acute Services Building (ASB) at Shoalhaven District Memorial Hospital (SDMH).

Cultural Capital is seeking expressions of interest for two opportunities within the Acute Services Building (ASB):

1. The Shoalhaven Street entrance to the hospital
2. Paediatric treatment areas

Artists may register their interest for one or both opportunities.

This EOI is open to artists living or working in, or with a connection to, the Illawarra Shoalhaven Local Health District. See page 15 for a map of the Illawarra Shoalhaven area.

EOI SUBMISSION KEY DATES

Closing Date: Monday, 17 February 2025

Closing Time: 5.00pm (AEST)

EOI SUBMISSION REQUIREMENTS

Applicants will submit a response that demonstrates their professional experience as an artist, designer or creative team relevant to the commission. Requirements for this submission are outlined on page 11.

All applicants should read the PDF excerpt of the Shoalhaven Hospital Arts in Health Strategy to ensure that their proposals are relevant to this document. It is an endorsed plan that covers the entire commissioning program for SDMH.

CONCEPT FEES

Artists will not be remunerated for their EOI submission.

Artists shortlisted through the EOI process will be asked to develop concept proposals for a fee.

Shoalhaven Street Artwork concept fee: \$3000

Paediatrics artwork concept fee: \$2000

EOI LODGEMENT

1. Submit the online form with your personal details to complete your submission:

<https://forms.office.com/r/FHxdejAqsd>

2. Submit a response in PDF format to hi-arts@health.nsw.gov.au

This is to be emailed as a single PDF file attachment (not exceeding 10MB). Use the subject line: (Insert Name) - Shoalhaven EOI Creative Response. Refer to submission requirements detailed on page 11.

For support with your submission contact:

Lily Keenan, Project Manager

lily@culturalcapital.city

Gina Mobayed, Project Director & Curator

gina@culturalcapital.city

PROJECT TIMELINE

17 Feb 2025 - EOI submissions due

April 2025 - shortlisted artists notified

April - May 2025 - shortlisted concept development

Late May 2025 - Shortlisted artists present concepts to Arts Committee. Selected artists contracted

Aug/Sept 2025 - installation of artwork

Early 2026 - ASB opens

ARTWORK BUDGET

The successful artist will be awarded the following fees:

Shoalhaven Street Artwork **\$100,000**

Paediatrics artworks **\$29,500**

Shortlisted artists will receive a project briefing regarding the artwork budget.

summary of commissioning process

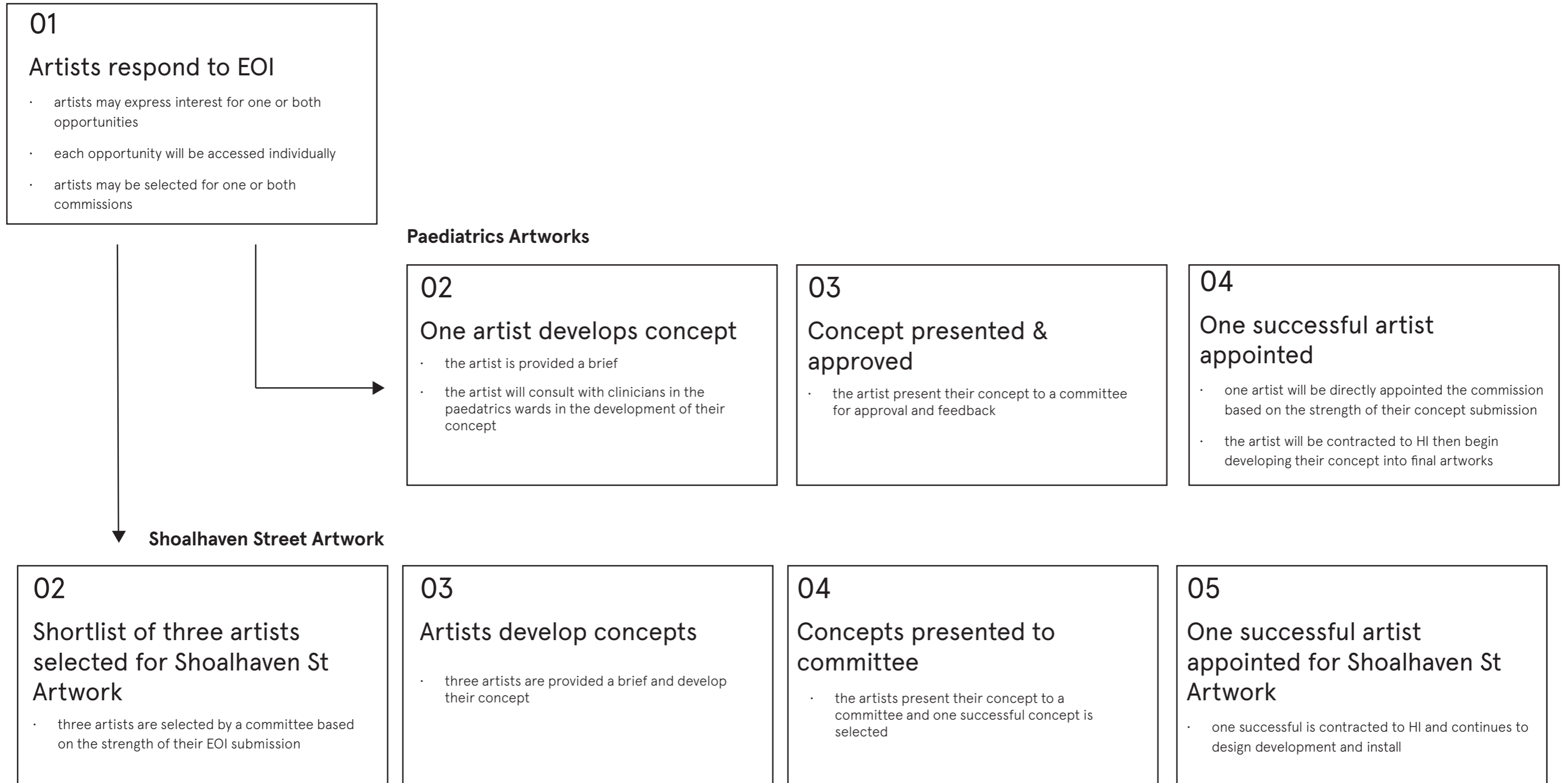

project overview

Shoalhaven District Memorial Hospital (SDMH) will welcome the addition of an Acute Services Building (ASB) to its campus. The ASB is scheduled for completion in 2026 and will elevate the current campus to the standards of quality and care expected from hospitals today.

The ASB is an entirely new building, constructed on a greenfield site within the existing campus. SDMH is located in Nowra and services an area within the Illawara Shoalhaven Local Health District (ISLHD) known as 'Shoalhaven'. This area comprises the Shoalhaven City Council Local Government Area, home to 108,500 people.

The ASB will house medical, surgical and geriatric inpatient units, mental health, cardiac outpatient, intensive care units as well as ambulatory care, medical imaging and rehabilitation treatment spaces. Working spaces for administrative and clinical staff, front of house and retail services are also included. Blocks B and D are also undergoing a refurbishment and are included in this strategy.

The art program responds to the needs and opportunities within the hospital community. The hospital sits on Jerrinja and Wandj Wandj Country and welcomes Aboriginal staff and consumers from across the Dharawal and Yuin nations. A significant Blackbutt tree sits right on campus and across the road, the Shoalhaven river curves its way toward the Pacific ocean.



curatorial vision

a canopy of care

Caring exchanges between all people, under the protective canopy of the hospital lies at the heart of this vision.

Within the grounds of Shoalhaven District Memorial Hospital sits an ancient blackbutt tree. The tree has a powerful presence, it reaches 38 metres skyward and its canopy spans 10 metres in diameter. It has been acknowledged by local Aboriginal community members as 'an important place to come back to, as a reminder of being on Country' (Yerrabingin, Design Jam 2022).

Today this monumental canopy stands strong as a marker of positive exchange between those within the hospital community. The curatorial vision brings this metaphor of 'caring exchange' into focus for the arts program.

By design, the hospital is like the canopy of the Blackbutt tree. Both are complex machinations where energy sources are captured to support life, where nourishment, resources and care are constantly exchanged between organisms. Neither the tree nor the hospital discriminate, they are places where everyone can visit to receive what they need. Here, exchanges can be seen as a method of care, one organism needing to interact with another.

This vision folds an arts program into the hospital that centres on these human principles.



Craig Walsh and Hiromi Tango, Five, 2013

opportunities by floor

This page gives an overview of opportunities across the footprint of the SDMH, ASB and Block B.

The opportunities in colour are the commissions that artists are invited to respond to by open EOI:

1. Shoalhaven Street Entry artwork - Level 0
2. Paediatric Treatment Rooms - Level 1, ASB
Paediatric Treatment Rooms - Level 2, Block B

Artists may register their interest for one or both of these opportunities.

BLOCK/LEVEL ART OPPORTUNITIES

ASB 0



SCULPTURE
IN THE GARDEN

SHOALHAVEN STREET
ENTRY ARTWORK

MULTI-FAITH ROOM

ASB 1

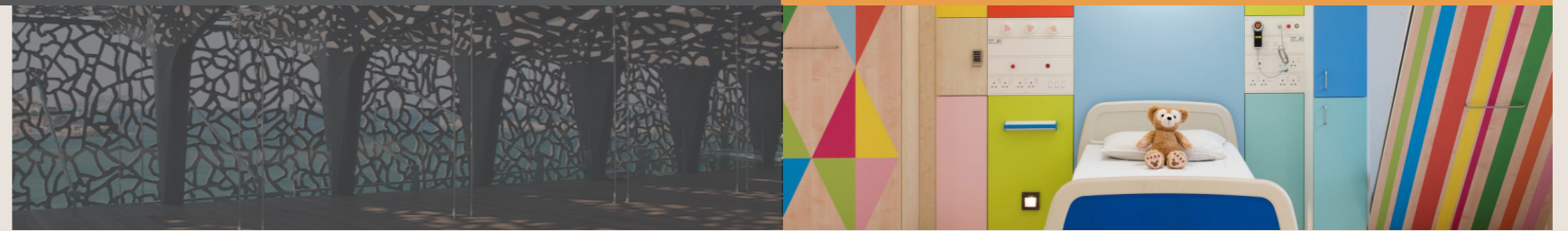

ENTRY SOFFIT

PAEDIATRIC TREATMENT ROOMS

BLOCK B 2



PAEDIATRIC TREATMENT ROOMS

ASB 4



MENTAL HEALTH SENSORY ROOMS

ADAPTIVE MURAL

OPPORTUNITIES
ACROSS ALL
FLOORS



EDUCATION AND ENGAGEMENT

GALLERY

WAITING ROOMS & GLAZING

0

shoalhaven street entry artwork

Artwork description

A large scale artwork commissioned for the entry stairwell on levels zero and one. The total length of the wall is approximately 23.5 metres.

Objective

This commission will welcome visitors from Shoalhaven Street, an alternative entry to the hospital.

This commission may take the form of a painting, light weight wall sculpture or applied design.

Conceptually, it will be responsive to the vision of 'a canopy of care' as it relates to a place of positive exchange and to the natural, local environment.

The artistic process to create this work may involve community collaboration with locals, including staff at the hospital.

Audience

Being a non-clinical space, this artwork is an opportunity to bring comfort and a sense of natural vitality to all visitors as they arrive at the hospital and journey through the new building.

Patients, staff, carers and locals will be able to access this artwork. It is accessible to the general public.



Guan Wei *Feng Shui*, 2004



Erica Seccombe 2022, Campbelltown Hospital Mural



Lara Merrett *time after time (sea and sky)* 2023



Daniel Boyd *Untitled* 2014, Museum of Contemporary Art Australia

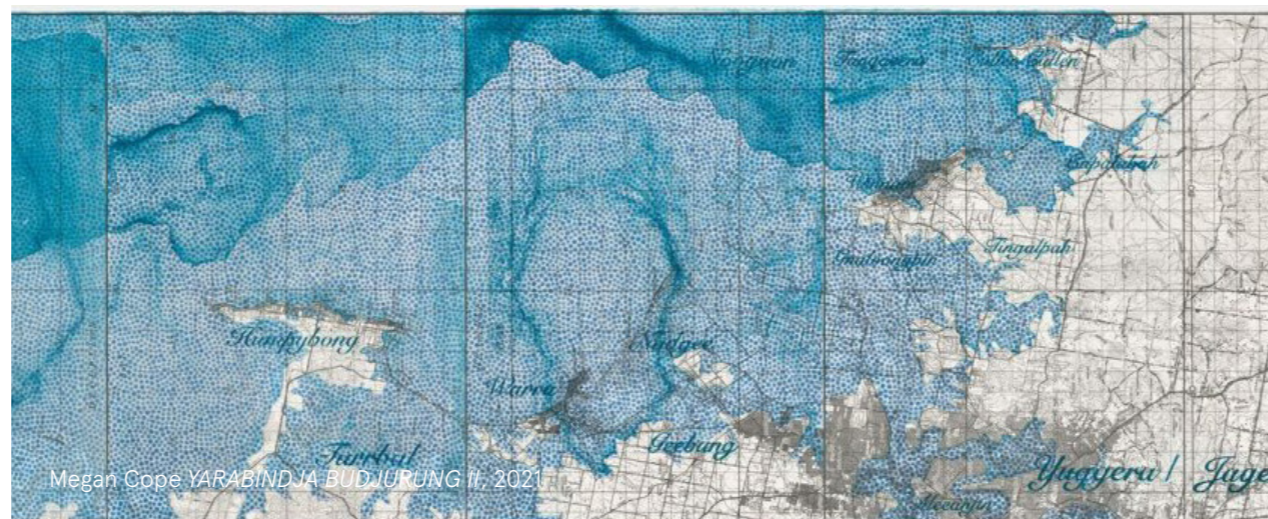

Megan Cope *YARABINDJA BUDJURUNG II*, 2021

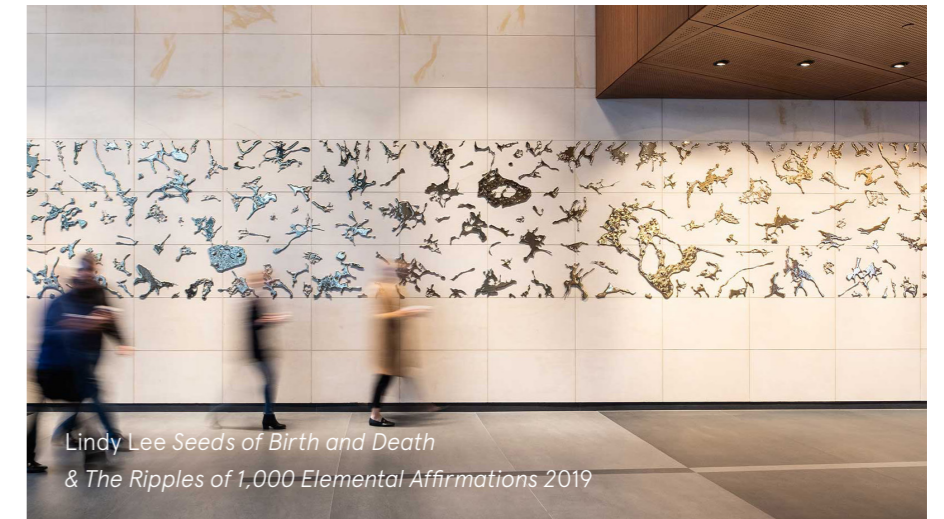

Lindy Lee *Seeds of Birth and Death & The Ripples of 1,000 Elemental Affirmations* 2019

1 2

paediatric treatment rooms

Artwork Description

Artworks for five Paediatric treatment rooms in the ASB, level 1 and refurbished areas of the existing hospital in Block B, level 2. These artworks will be installed as printed vinyl on walls or ceilings.

Objective

Artists are invited to develop five artworks that are joyful, colourful and uplifting. The artworks will be a point of distraction to patients during their treatments. The artist may also consider coloured patterns, playful imagery or local natural systems, such as rivers and ocean ecosystems to offer immediate connection and interest.

Audience

This suite of vinyl artworks aims to appeal specifically to a core audience of people aged 4 - 13 years but the spaces will welcome people of all ages.

These artworks are in clinical floors and not accessible to the public.



considerations common to both opportunities

1. The key objective for these commissions is to create a calm and soothing environment for patients and staff, offering interest and distraction in hospital spaces.
2. Clinical floor commissions hold the potential to be transformative and exert a substantial, immediate influence on the wellbeing of patients and staff.
3. Consideration should be given to the accessibility needs of the people using these locations. People may have different cognitive abilities, have physically limiting bed-based conditions or mobility requirements
4. While the works should help distract the patient from a distressful experience, they should also compliment the clinical requirements of the space and support clinician to patient communication and treatment
5. Infection control requires that all surfaces can be wiped down and regularly cleaned
6. Both of the EOI opportunities should consider the curatorial theme of 'A Canopy of Care'

EOI submission and process

Artists are encouraged to get in touch with any queries, to seek support to submit their expression of interest or discuss alternative submission methods i.e email, video or written

Lily Keenan, Project Manager

lily@culturalcapital.city

Gina Mobayed, Project Director & Curator

gina@culturalcapital.city

Resources

Shoalhaven Hospital Arts in Health Strategy 2023 (selected chapters)

Engagement Report 2023

[Click this link to view resources](#)

Submission

1. Submit the online form with your personal details to complete your submission:

<https://forms.office.com/r/FHxdejAqsd>

2. Submit a response in PDF format to hi-arts@health.nsw.gov.au by Monday, 17 February 2025, 5pm.

This is to be emailed as a single PDF file attachment (not exceeding 10MB). Creative response email will be credited in the subject line as: "(Insert Name) - Shoalhaven EOI Creative Response". The Creative Response must include the following information:

- full name
- Artist/Creative Team bio and CV (max two pages) or link to website
- up to 10 images of previous work
- Creative response outlining which opportunity (1 or 2 or both) the artist/creative team wishes to respond to and how they will approach the commission (max 250 words per opportunity)

Process

EOIs will be reviewed by a selection panel comprising representatives of Health Infrastructure, Shoalhaven Hospital Redevelopment teams and external advisors.

A number of artists/creative teams will be shortlisted from this process – shortlisted artists enter a subsequent round of competitive procurement. Each shortlisted artist will be paid a fee between \$2000-\$3000 to develop a concept.

Selection Criteria

Artists/creative teams will be selected to progress to the next stage based on the below criteria:

1. Work and live within, or have a connection to, the Illawarra Shoalhaven Local Health District footprint. For more information see page 15.
2. Creative practice: work in a style complementary to health care environments.
3. Demonstrated experience of artist/creative team as relevant to this project.
4. Availability to meet project timelines.

consultation

It is extremely important that the artworks in hospitals are embraced and accepted by the diverse communities receiving treatment, visiting or working in the hospital, to ensure that the artworks are sensitive to the values of local community.

Consultation - Paediatric Artworks

The artist who is selected to create artworks for the paediatric wards will consult with paediatric clinicians to develop their concept. This engagement will take the form of 1-2 sessions, either online or in-person, where clinicians will share key values, needs and constraints for the artist to consider when developing their concept. Consultation may continue during design development. The project team, Cultural Capital, Health Infrastructure and ISLHD will support the artist to coordinate and structure their consultation.

Consultation - Shoalhaven Street Artwork

Shortlisted artists will meet with representatives from the Multicultural Health Unit (MHU) and the Aboriginal Health Unit (AHU) in the preparation of their concept. This consultation will be 2 x video/in person meetings and facilitated by Cultural Capital. In this meeting, the Unit Representative will speak generally about values and experiences of their community in the hospital. The artist will have the opportunity to ask questions. Minutes from these meetings will be provided to artists.

The successful artist for this commission may wish to incorporate community engagement or co-design into the creation process of this work, this will be outlined further for shortlisted artists in the artist brief.

terms & conditions

1. By submitting an Expression of Interest (EOI), artists and creative teams accept the Terms & Conditions associated with the commissions.
2. The EOI form must be completed in full to be eligible, including submitting via email the Creative Response as outlined on page 11
3. Artists/creative teams must be Australian citizens or have permanent resident status.
4. Artists/creative teams who are not 18 or older, must provide details of their parent or guardian with their submission.
5. Artists/creative teams must hold or be willing to arrange product and public liability and professional indemnity insurance coverage.
6. The selected artist/creative team gives non-exclusive rights to Health Infrastructure and Illawarra Shoalhaven Local Health District to publish the selected concepts on social, print and other media as appropriate. Selected concepts will be attributed to the artist/creative teams.
7. All examples of previous works submitted for the EOI must be original works created by the artist/creative team who is submitting the EOI.
8. The decision of the selection panel regarding the selected artist/creative team will be final. In the event of any other dispute, the decision of the General Manager, Shoalhaven Hospital shall be final.
9. Artists/creative teams will not be paid for EOI submissions.
10. Artists/creative teams own the copyright of their work.
11. Use of the concept by the artist/creative team shall attribute Health Infrastructure and Illawarra Shoalhaven Local Health District, subject to separate agreement.
12. Health Infrastructure reserves the right not to proceed with the commissions without prior consultation.

Appendix A

further reading

Illawarra Shoalhaven local health district

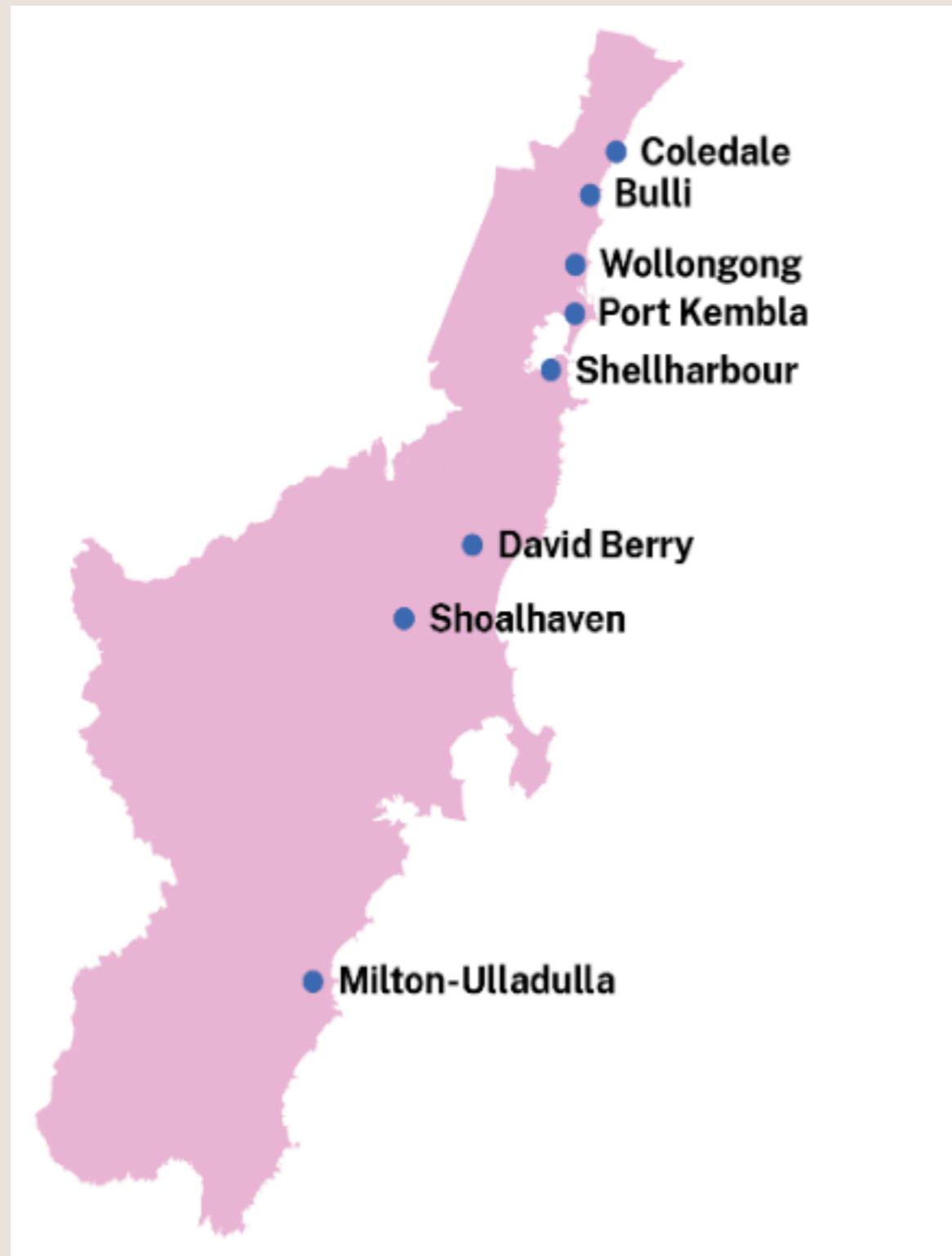

Illawarra Shoalhaven Local Health District (ISLHD) covers an area of 5,687 square kilometres, along the coast in NSW from Helensburgh in the north to North Durras in the south.

Dharawal and Yuin peoples are the traditional custodians of the land, which encompass five language groups: Wadi Wadi, Dharawal, Wandandian, Walbanga and Yuin.

In 2021 the estimated population was 404,000 residents, and over the decade to 2031, the overall population is projected to increase to 470,000.

Public hospitals in ISLHD

- Bulli
- Coledale
- David Berry
- Milton Ulladulla
- Shellharbour
- Shoalhaven
- Wollongong

For more information visit the [Health NSW website](#).

the design vision

Throughout the exterior and interior, the ASB reflects the local landscape, with the forms of the Shoalhaven River inspiring design details.

The river, with its unique composition of elements, textures and colours is a landmark that residents connect with. Conrad Gargett have brought this element into the interior design of the hospital, and this strategy continues the conversation by positioning the neighbouring and significant tree, the Blackbutt, at the centre of the curatorial vision.



Render of new Shoalhaven Hospital entrance. Image: supplied



Conrad Gargett design lighting reference. Image: Supplied



Conrad Gargett design ceiling reference. Image: Supplied



Shoalhaven River. Image: Supplied

stakeholder engagement

To inform the curatorial approach to the art program, Cultural Capital completed comprehensive stakeholder engagement with key user groups in June and July of 2023.

Groups consulted included:

- Clinicians who will treat patients in the wards/clinics at the new hospital building
- Elders and other representatives from the Aboriginal community
- Staff representatives from the multicultural community and the Aboriginal community
- Staff at Shoalhaven Hospital, beyond clinical practitioners
- Patients who have received treatment at Shoalhaven Hospital

Key findings:

- **Present local artists and community collaborations**
- **Celebrate local natural environments and vistas**
- **Enhance cultural safety**
- **Provide spaces for staff, patients and their families to connect**
- **Alleviate stresses of the hospital environment**
- **Provide tactile, interactive or sensory experiences**
- **Create moments that evoke daily life outside the hospital**
- **Provide art forms that are appropriate, safe and professional**

For more information see the [Stakeholder Engagement Report](#)

Appendix B

floor plans, elevations & indicative art locations

shoalhaven st mural, level 0 & 1, elevation

Notes

- The total surface area of the mural is approximately 96.84 square meters
- There is handrail along the stairs.
- MDF wall load rating is 12kg/m²
- Any additional load or 3D work would need to be reviewed by engineer. Additional support maybe required

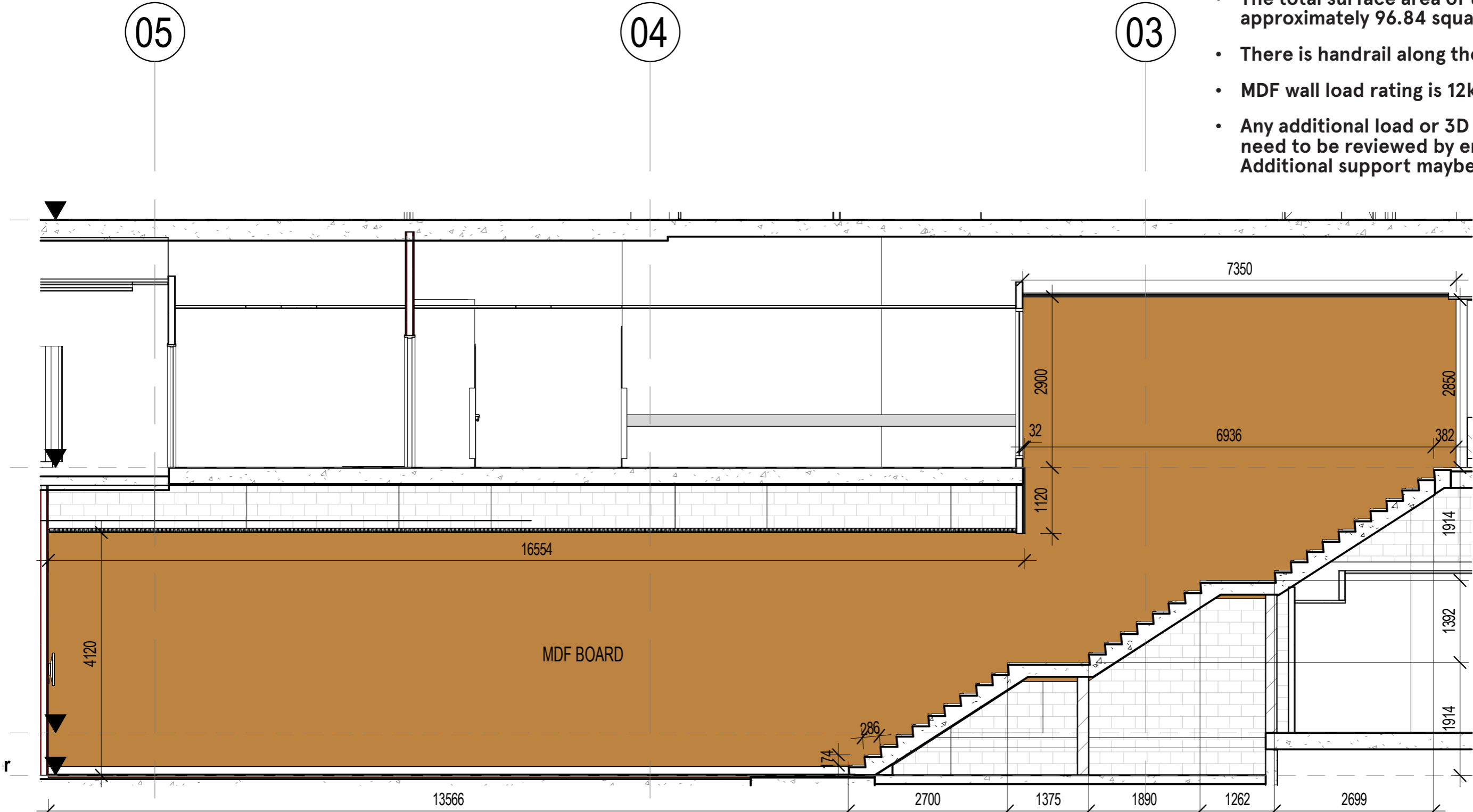

shoalhaven st mural, level 0, floor plan

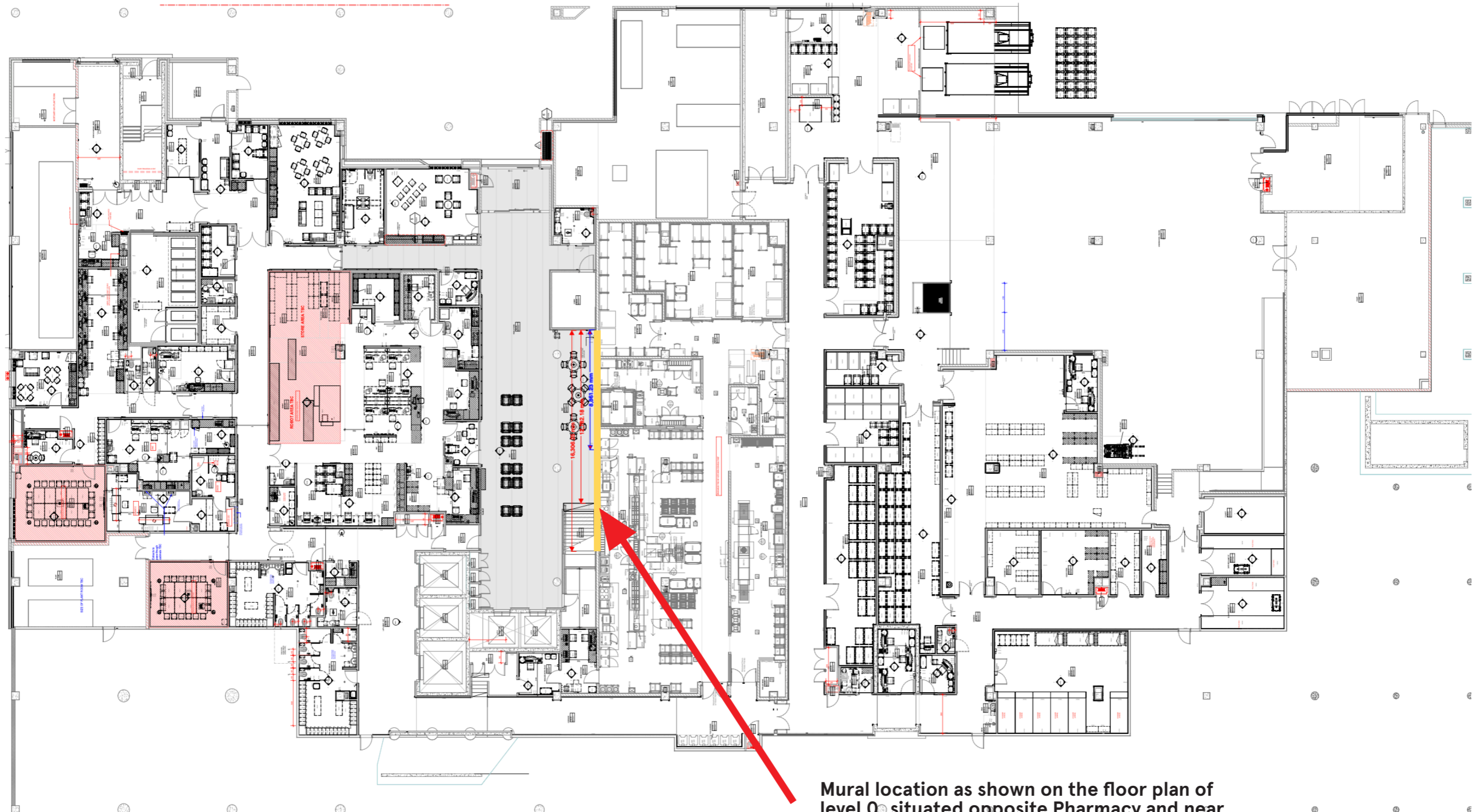

Mural location as shown on the floor plan of level 0, situated opposite Pharmacy and near casual seating area.

Please note, the mural extends through the staircase area onto the wall of level 1, as shown in the elevation on page 17.

shoalhaven st mural, level 1, floor plan

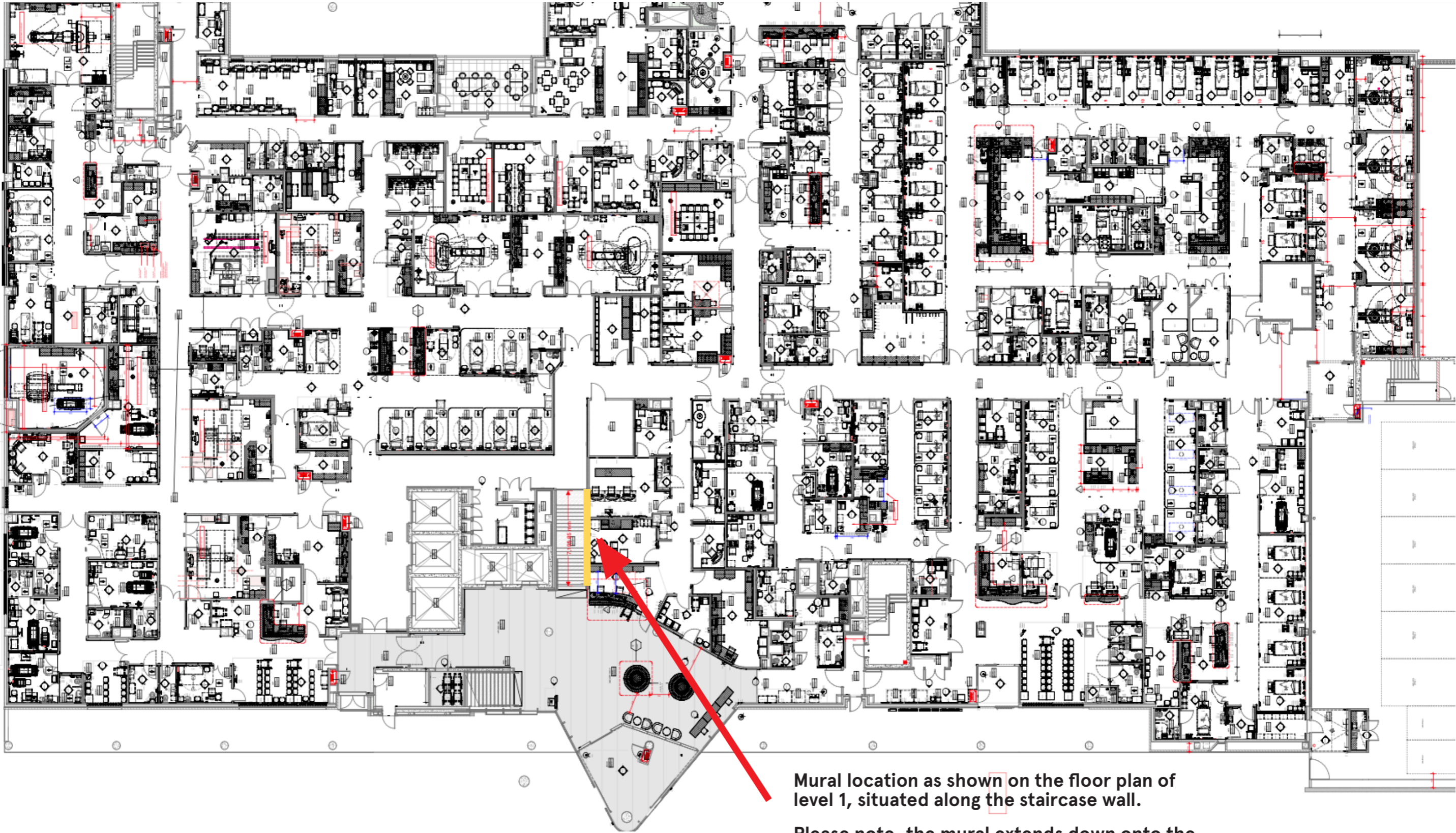

Mural location as shown on the floor plan of level 1, situated along the staircase wall.

Please note, the mural extends down onto the wall of level 0, as shown in the elevation on page 17.

shoalhaven st mural, level 0, casual seating area

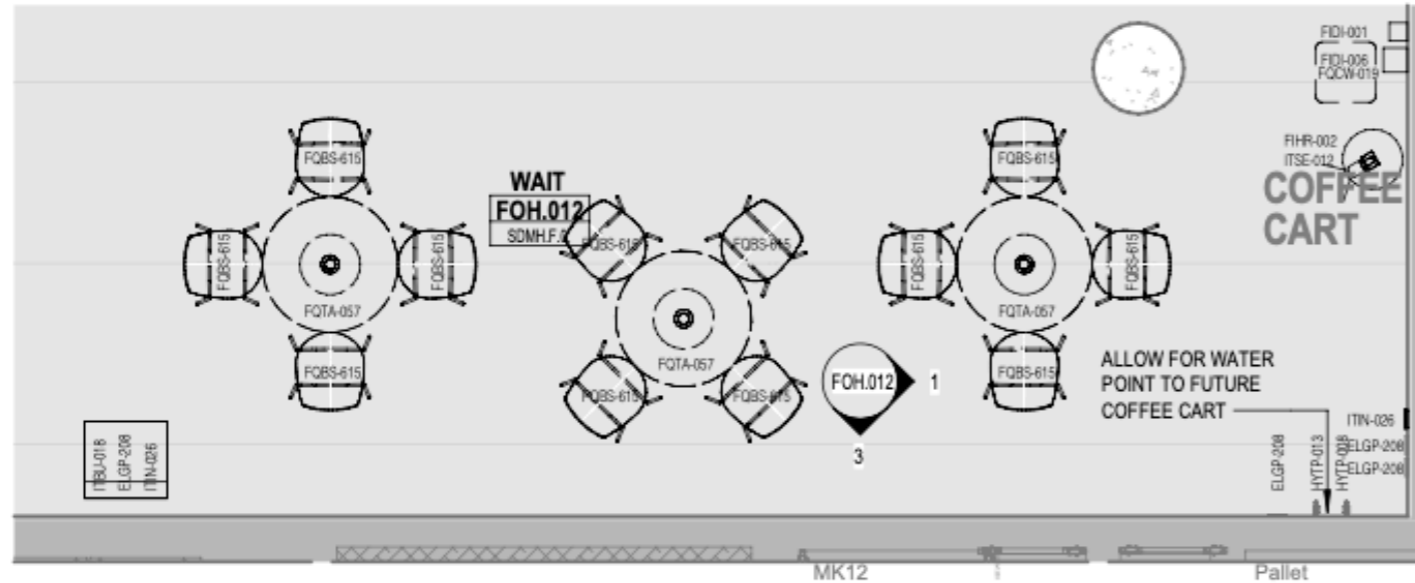

PLAN

FOH.012.3 - WAITING			
CODE	DESCRIPTION	QTY	GROUP
ELGP-208	GPO: double, wall mounted	4	1
FDI-001	DISPENSER: alcohol based hand rub	1	2
FDI-006	DISPENSER: cleaning wipes	1	2
FIHR-002	BRACKET: for CCTV camera, ceiling mounted	1	1
FCBS-615	CHAIR: dining, coffee cart	12	3
FQCW-019	BIN: waste, general, 50L	1	3
FQTA-057	TABLE: round, 900 diam, work height	3	3
HYTP-008	OUTLET: cold water	1	1
HYTP-013	OUTLET: hot water	1	1
ITBU-018	KIOSK: public information system	1	1
ITIN-026	OUTLET: data, double RJ45, wall mounted	2	1
ITSE-012	CAMERA: CCTV	1	1

Notes

- The mural will extend into the seating area on level 0 but it will not be limited to this area
- the nominated area is outlined in the elevations on this page, with a provision for a coffee cart (unconfirmed)
- The artist should consider that this will be a high traffic area, and that seats and tables close to the mural may cause scuff marks/wear and tear.
- Visitors may spend longer time at this section of the mural while they enjoy a coffee or food

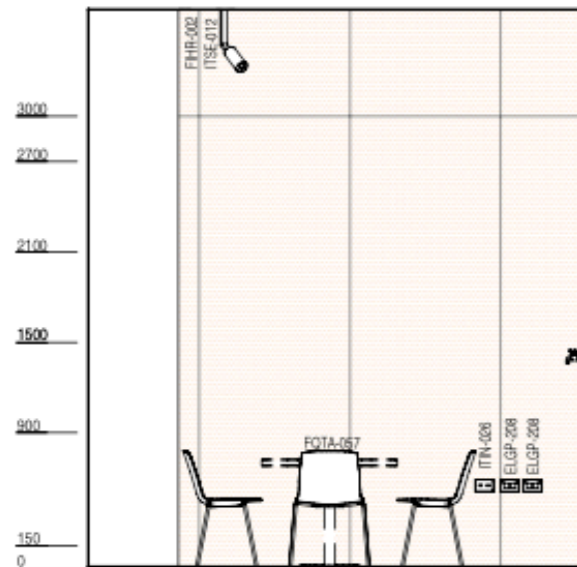

ELEVATION 1

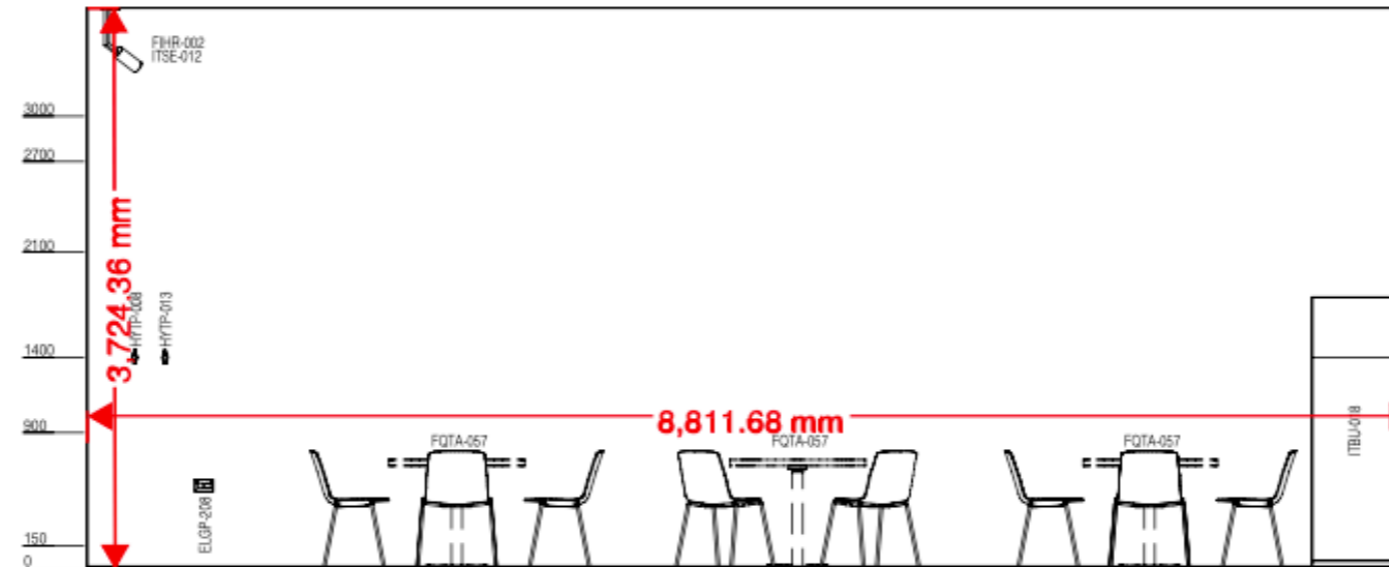

ELEVATION 2

paediatrics treatment rooms, level 1, ASB floor plan

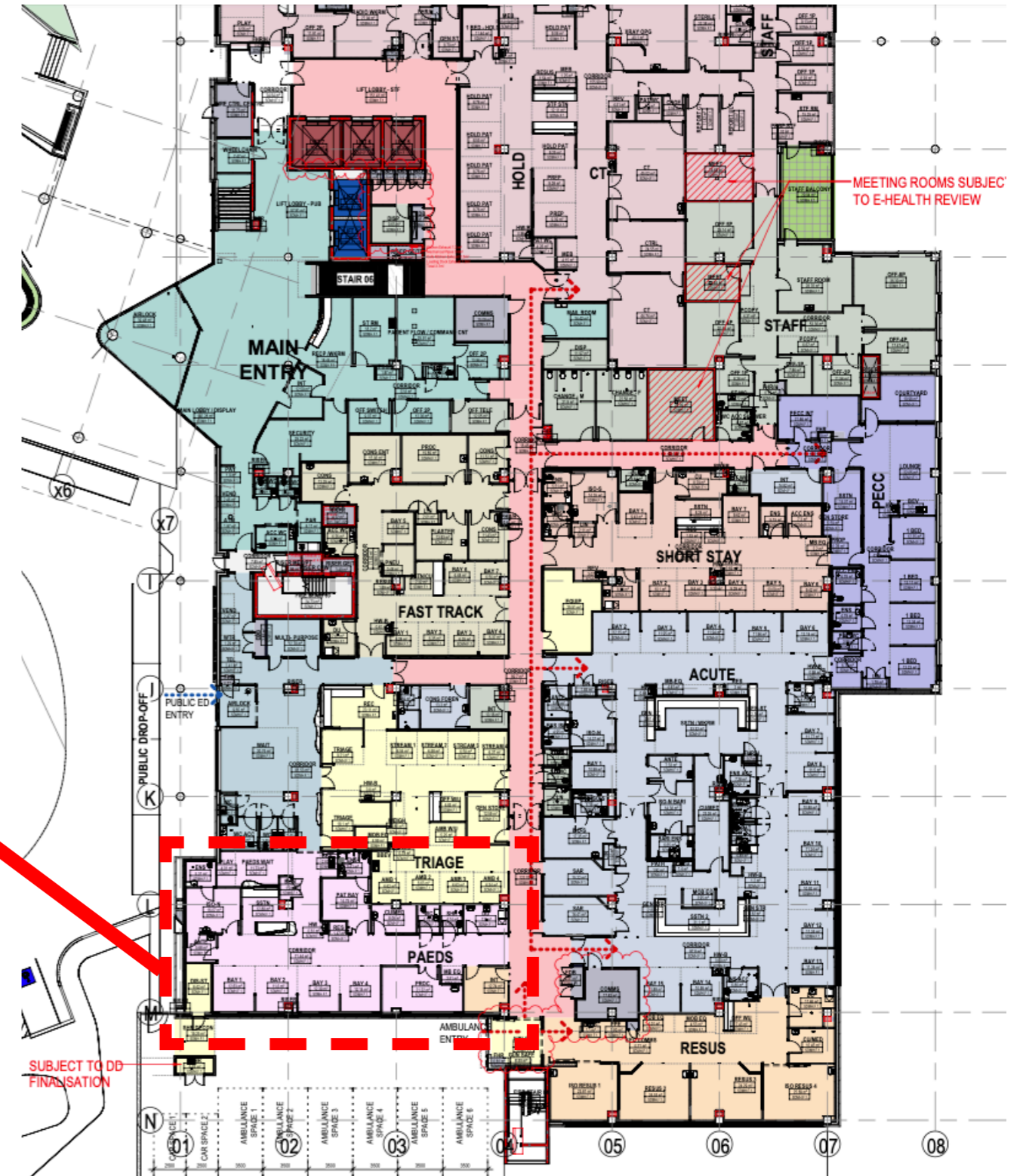
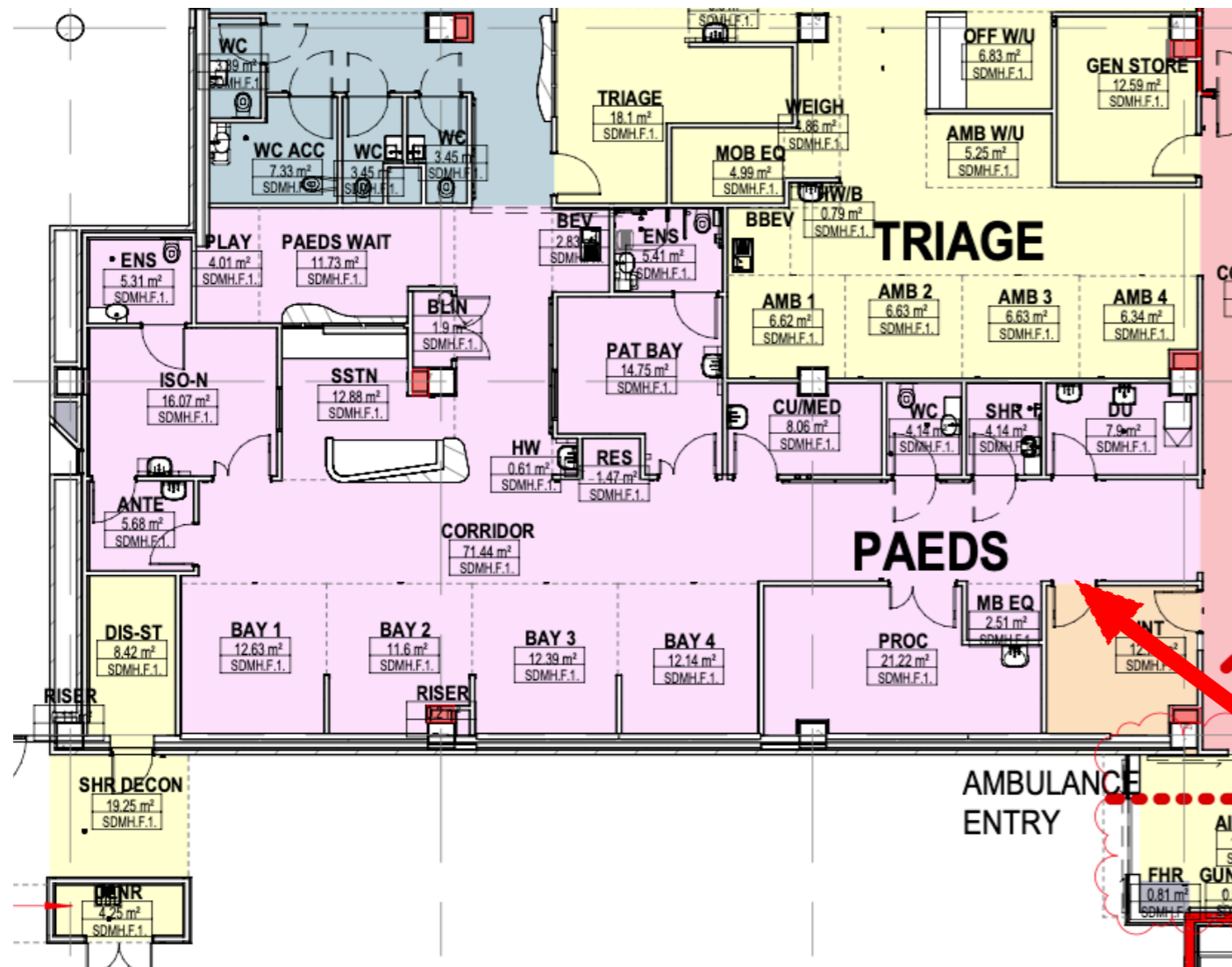

paediatric treatment room #1 - medical imaging wait area

level 1, ASB building

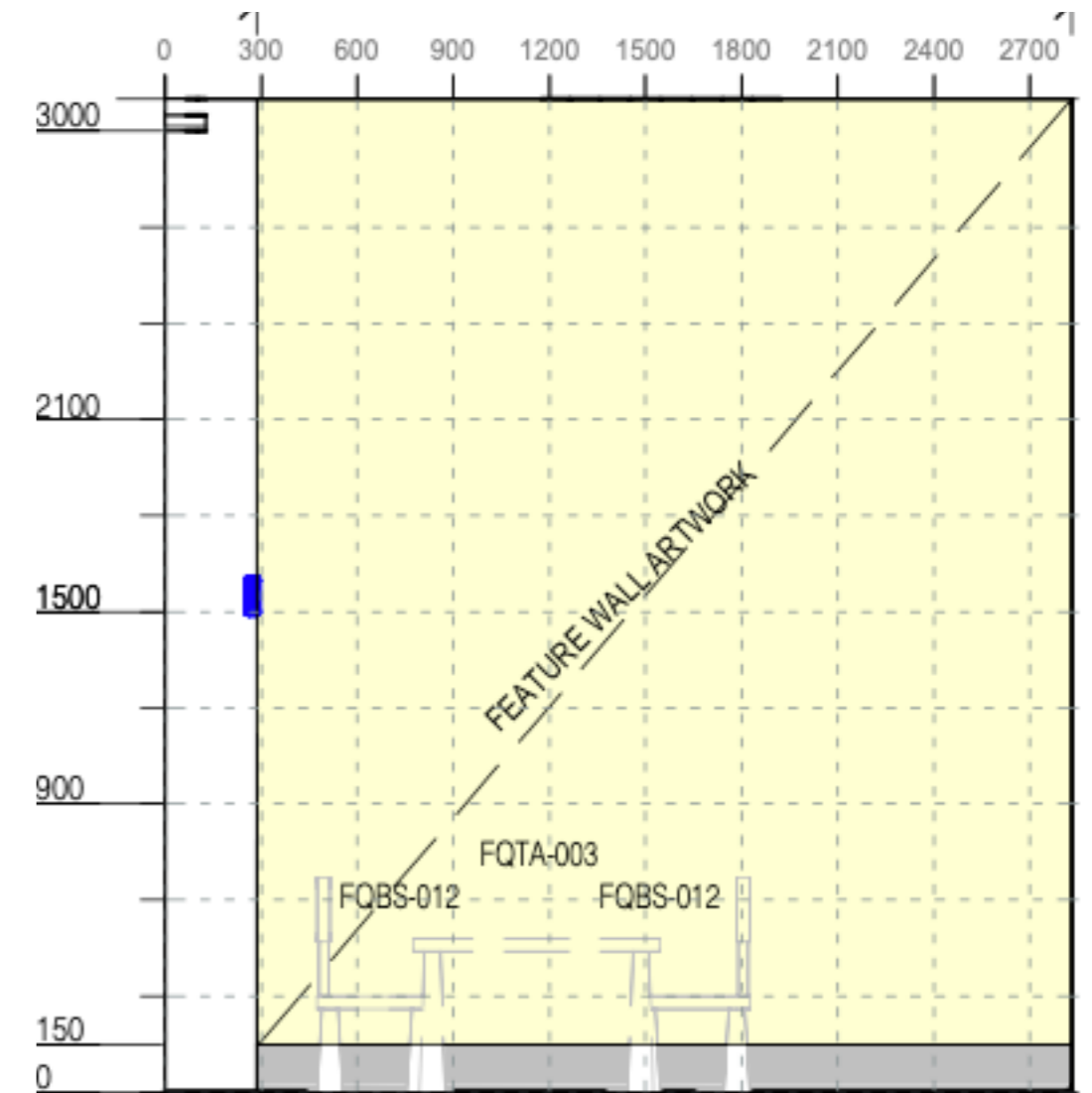
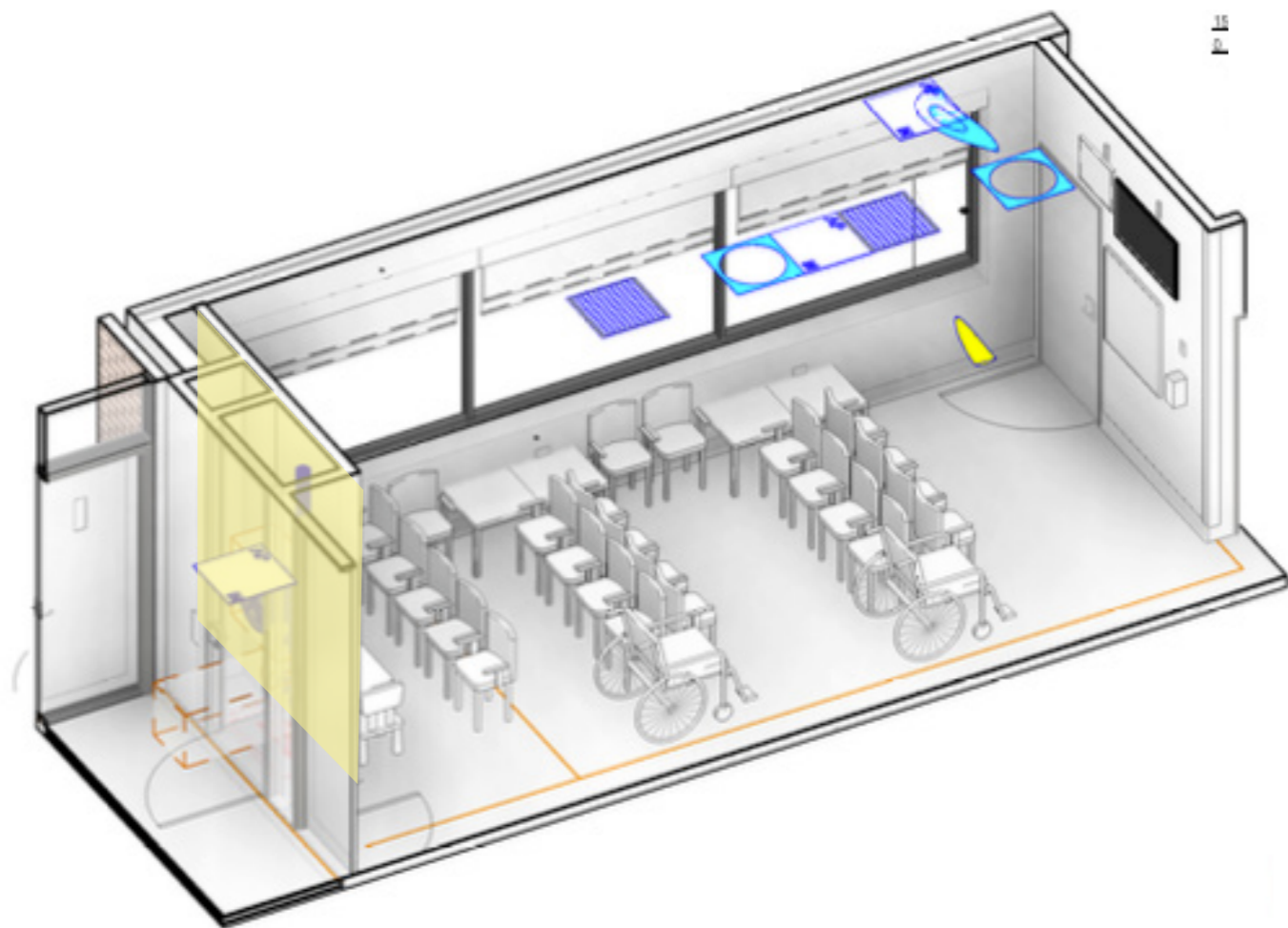

ELEVATION 4

paediatric treatment room #2 - wait & play area

level 1, ASB building

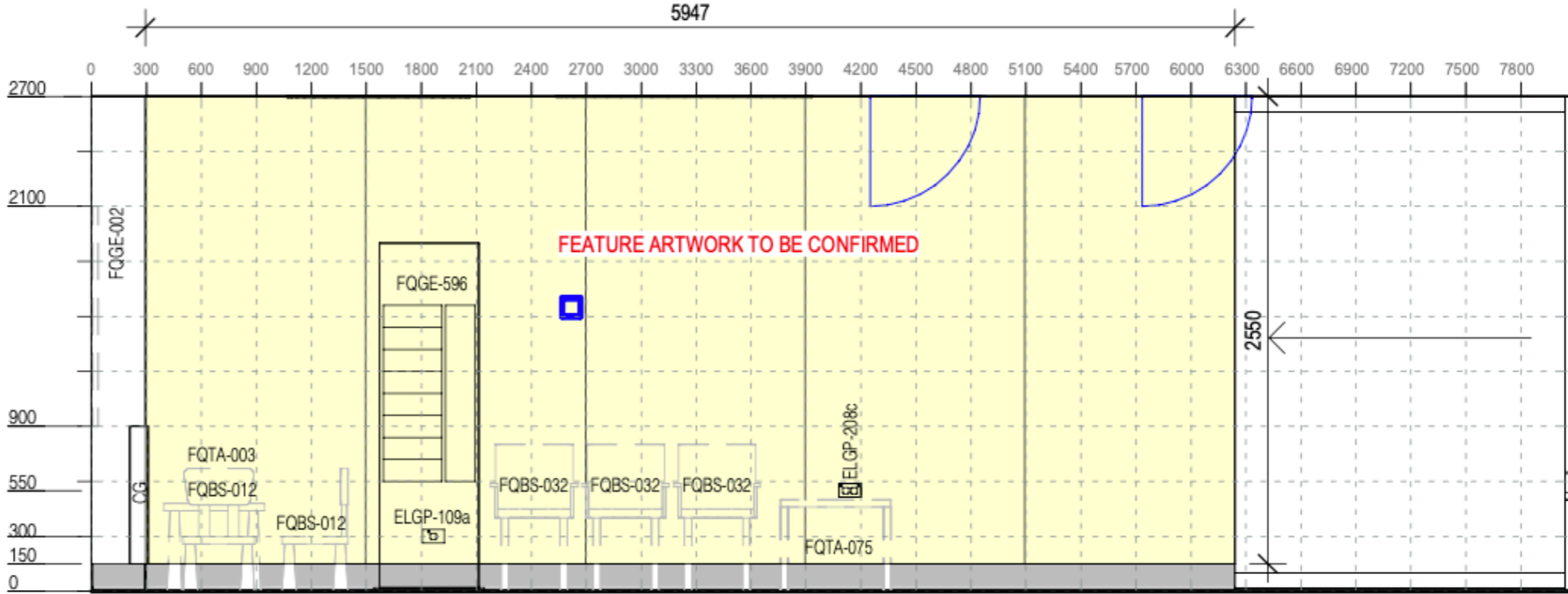

paediatric treatment room #3 - procedure room

level 1, ASB building

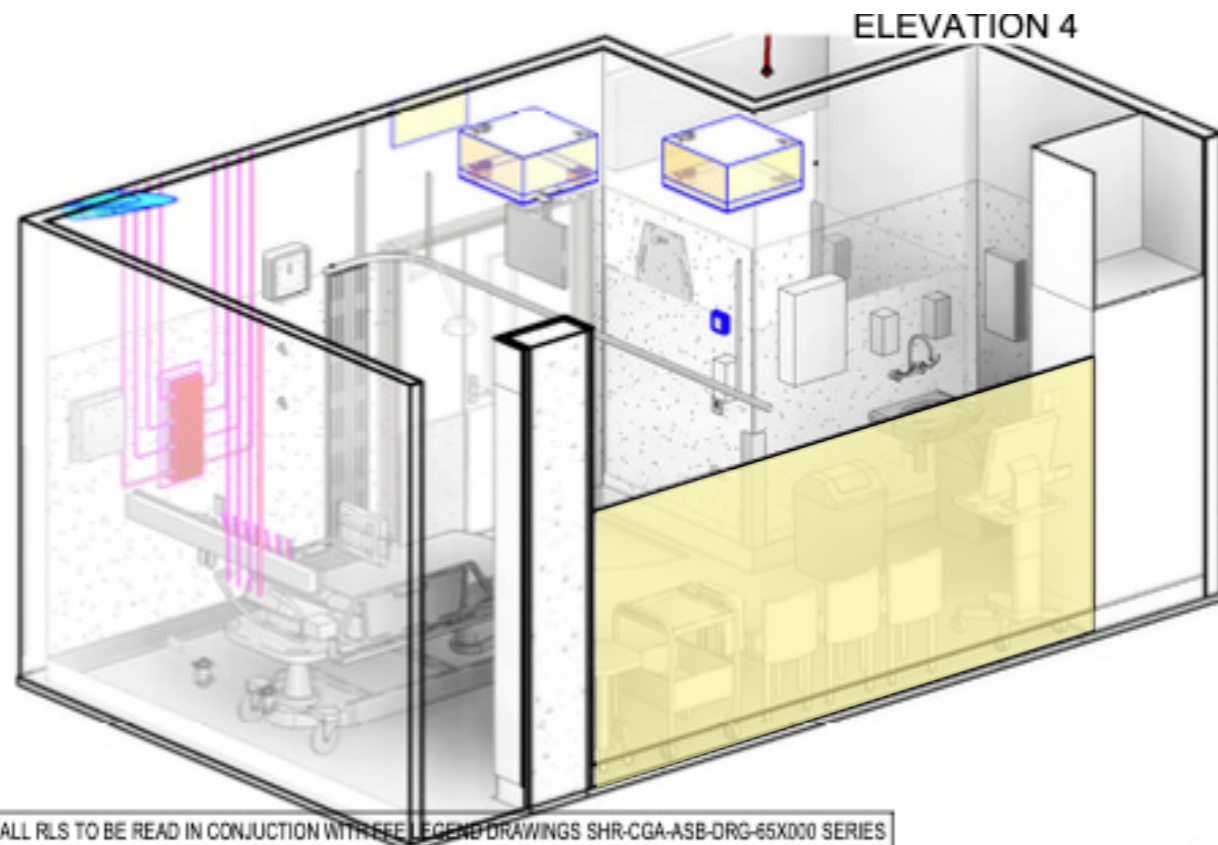
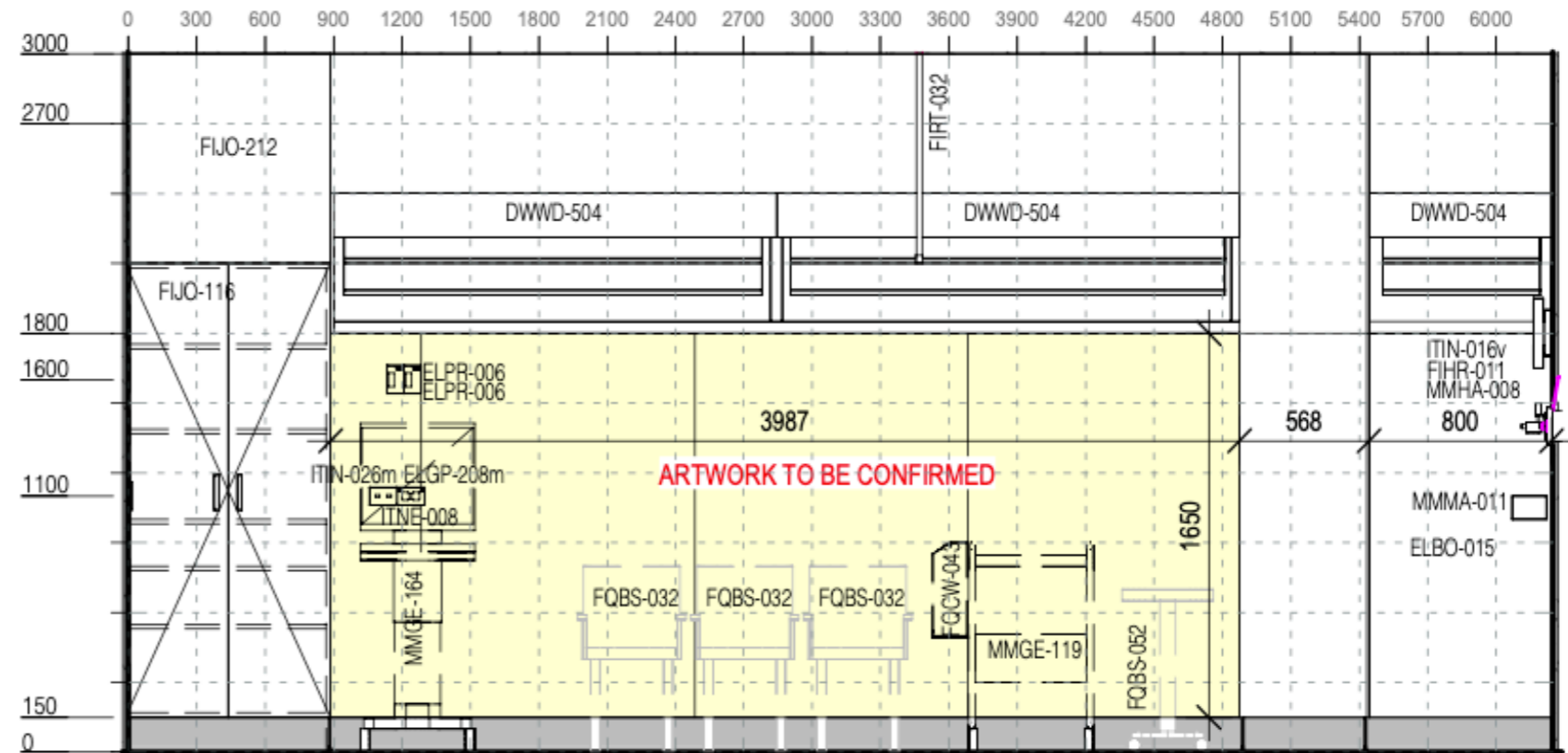

ALL RLS TO BE READ IN CONJUNCTION WITH REFERENCE LEGEND DRAWINGS SHR-CGA-ASB-DRG-65X000 SERIES

paediatric treatment room #4 - ambulatory care play area

level 2, block B, refurbishment

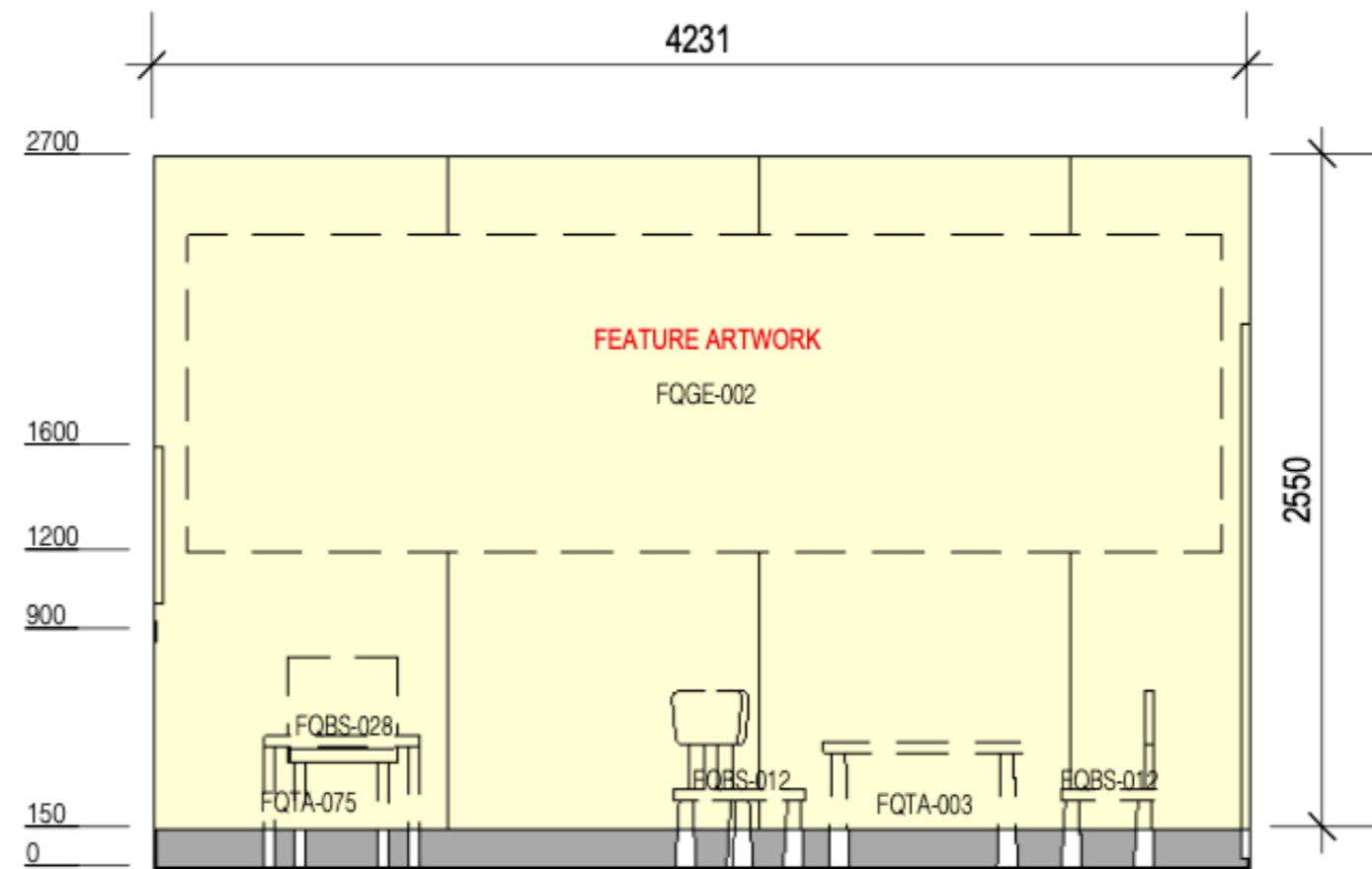
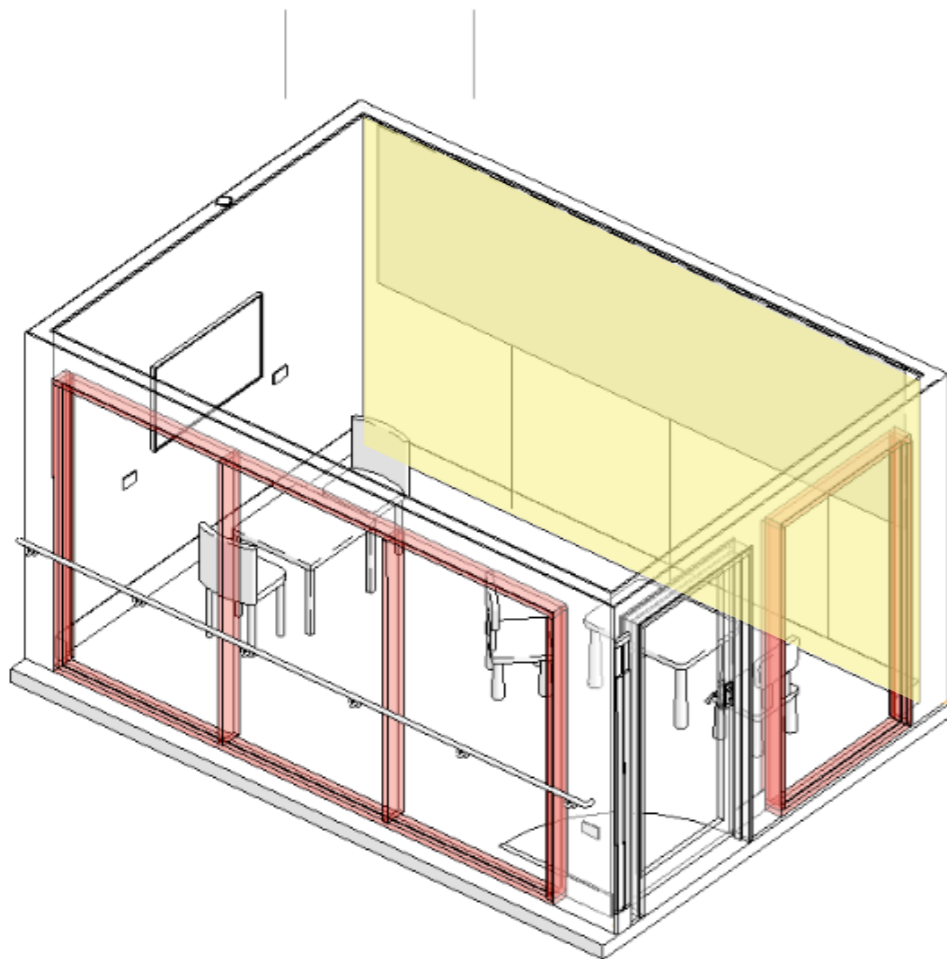

paediatric treatment room #5 - paediatric assessment unit

level 2, block B, refurbishment

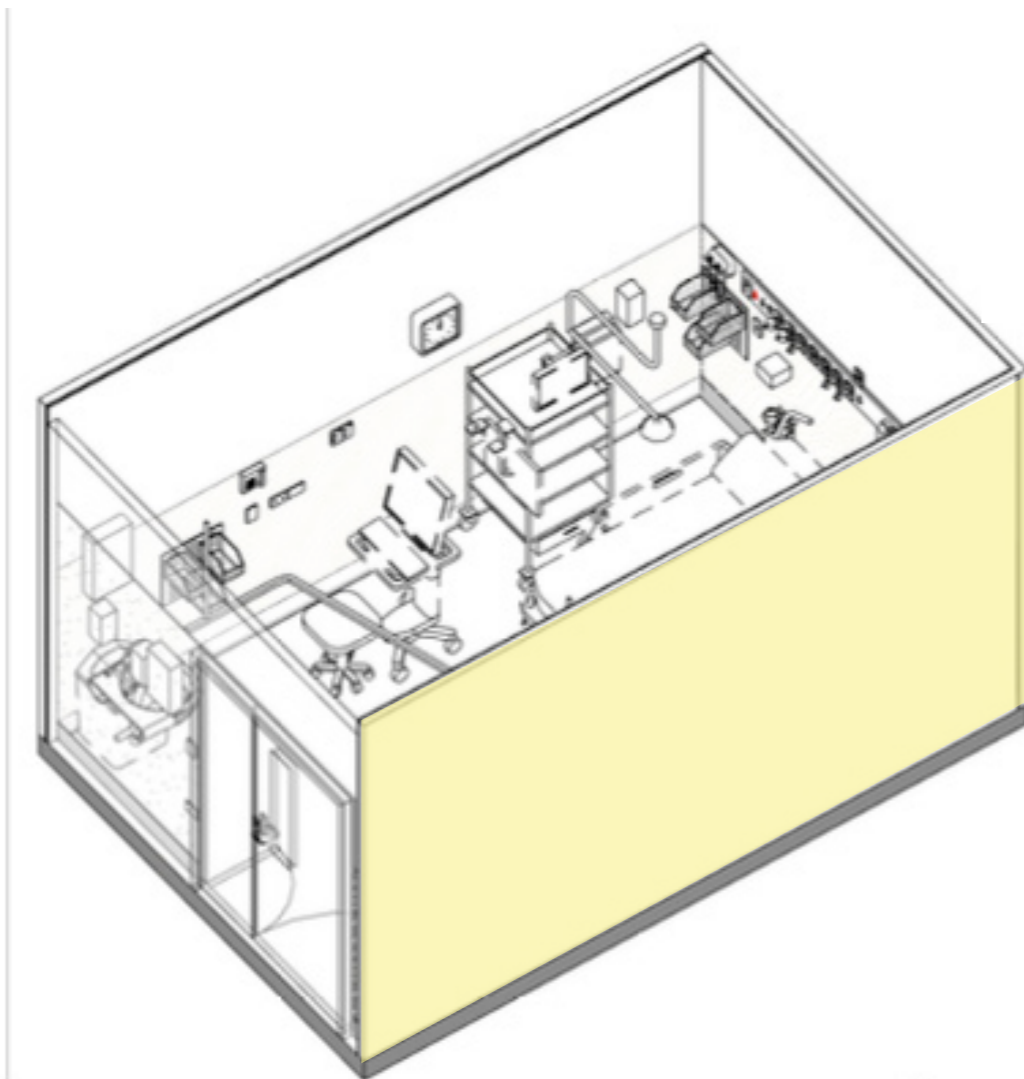

ALL RLS TO BE READ IN CONJUNCTION WITH FFE LEGEND DRAWINGS SHR-CGA-ASB-DRG-65X000 SERIES

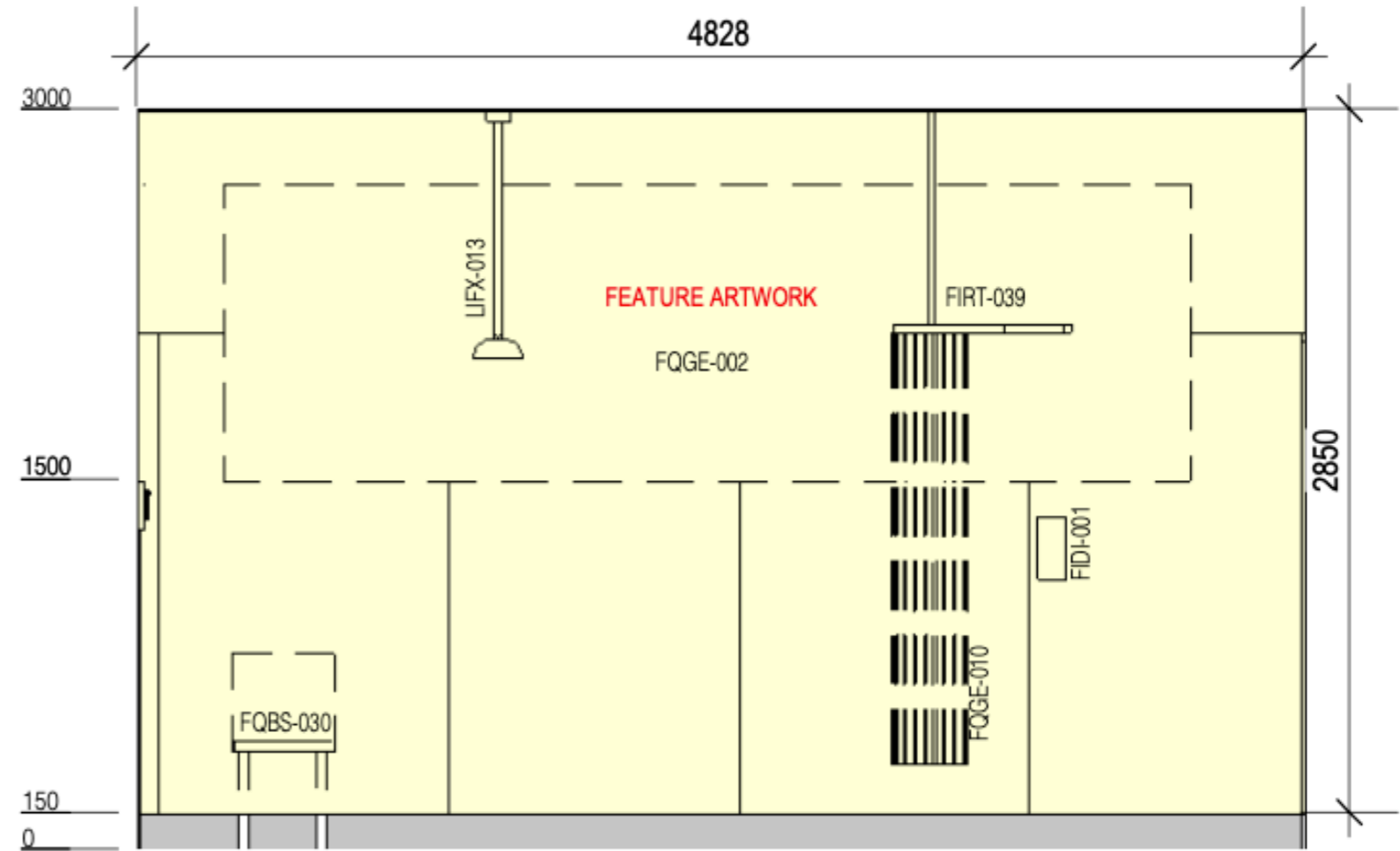

culturalcapital

LEVEL 2, 7 KELLY STREET

ULTIMO, NSW 2007

WWW.CULTURALCAPITAL.CITY

Lily Keenan, Project Manager

0402552465

lily@culturalcapital.city